Turning grooves and plunge cuts TISIS Optimove

Contents

1	The easy way to program your grooves and plunge cuts!	3
2	Turning a gorge with the G971	4
3	Turning a plunge cut with the G972	5

1 The easy way to program your grooves and plunge cuts!

No more tedious programming of grooves and plunge cuts. TISIS provides an easy way to program grooves and plunge cuts.

Two functions allow for easy programming:

- G971: for turning grooves
- G972: for turning plunge cuts

These two macros can be used for controlling external and internal turnings.

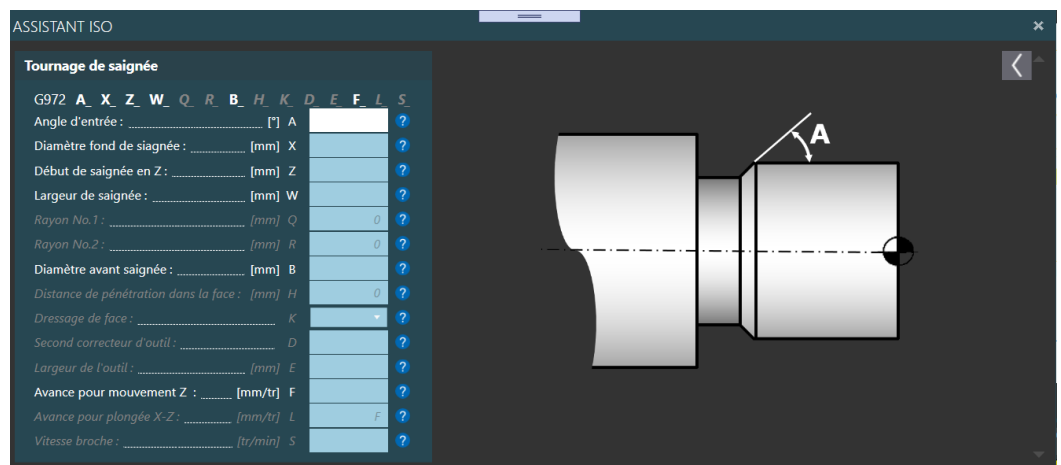
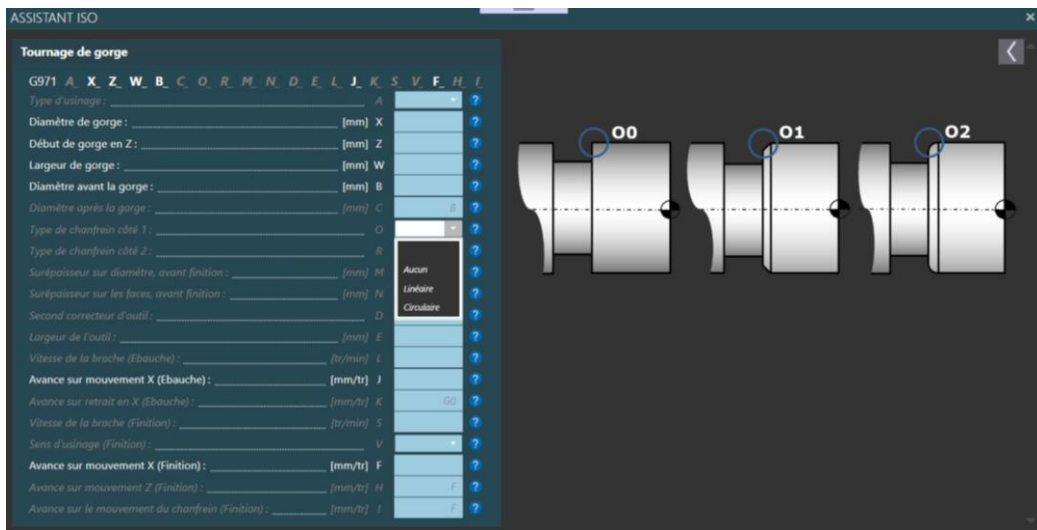

2 Turning a gorge with the G971

Function G971 is used to turn gorges.

The following can be configured:

- The dimensions of the gorge
- The shape of the gorge
- The machining process for the gorge

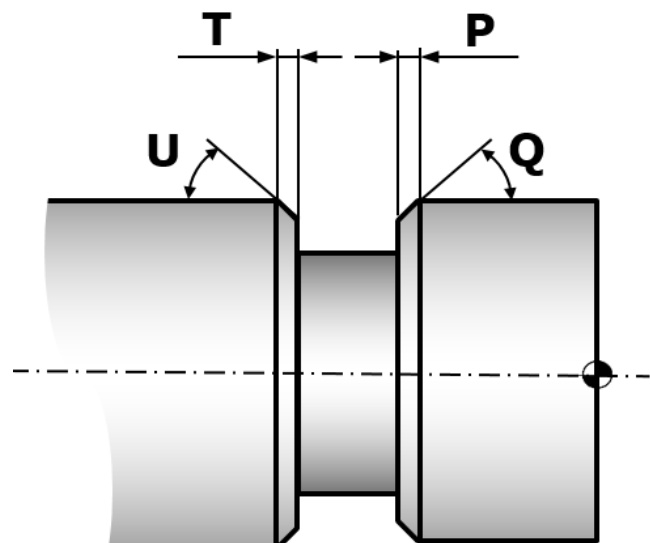
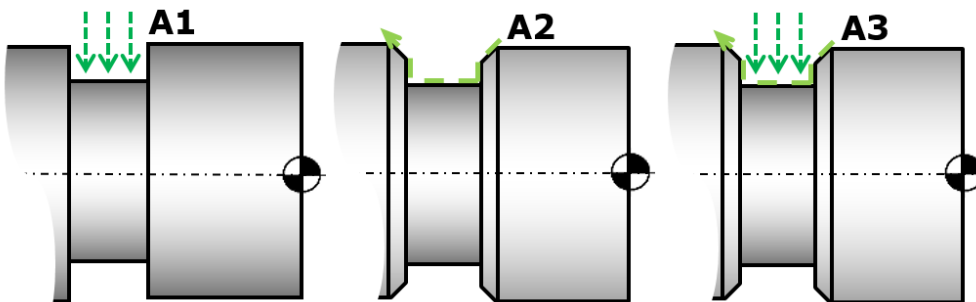
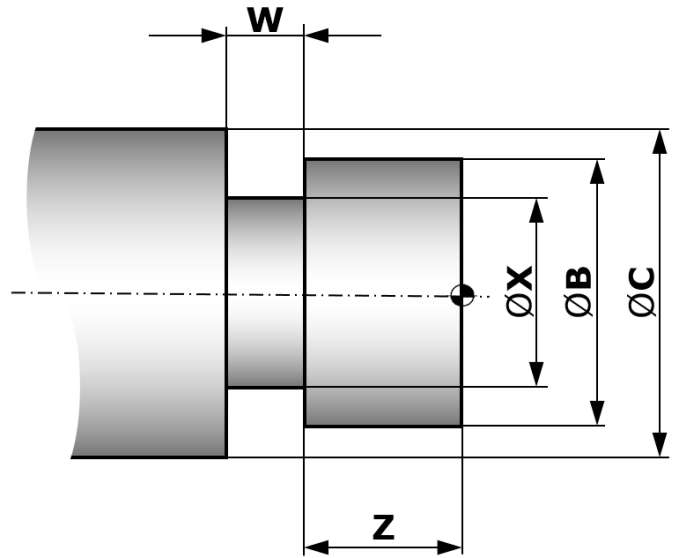

3 Turning a plunge cut with the G972

Function G972 is used to turn plunge cuts.

The following can be configured:

- The dimensions of the plunge cut
- The shape of the plunge cut
- The machining process for the plunge cut

